

# PRODUCT INFORMATION

THE  
**ULTIMATE™**  
4-STROKE OUTBOARD

# DF40A / 50A / 60A

FOUR STROKE ELECTRONIC FUEL INJECTION WITH LEAN BURN



NMMA  
2011 Innovation Award  
Winner



Way of Life!

# Delivering Superior Fuel Efficiency and High Performance— The New Generation DF40A, 50A and 60A

Today's outboards must be highly economical and deliver environmentally responsible operation. Using our unique vision and innovative technologies, we at Suzuki are constantly seeking new ways to provide our customers all over the world with outboards that meet these requirements and deliver satisfaction and excitement.

The DF40A, 50A and 60A are the latest addition to Suzuki's fleet of fuel-efficient new generation four-stroke outboard motors. Suzuki engineers have combined a high performance DOHC (dual overhead cam) engine with Suzuki's Lean Burn Control System to create an outboard that delivers superior power and performance along with top-level fuel economy.

Based on Suzuki's proven in-line three-cylinder design with four valves per cylinder, this engine design utilizes a highly efficient air intake system that delivers maximum effectiveness in the high rpm range for high performance power. These are the only engines in the 40 / 50 / 60 HP outboard class to offer DOHC performance, and also the only engines in this class to incorporate a maintenance-free, oil-bathed timing chain, which provides increased durability. Additional features include electronic fuel injection, Suzuki's easy start system, and a large capacity 19A alternator.

With larger displacements for increased power and performance, Suzuki's Lean Burn Control System for improved fuel economy, and designs that are more compact and lighter in weight than their predecessors, the DF40A, DF50A and DF60A are an excellent choice for today's boaters.

## Features

- High performance DOHC 12-valve engine
- Suzuki's innovative Lean Burn Control System delivers remarkable fuel efficient operation
- Electronic Fuel Injection delivers optimum performance
- Maintenance-free timing chain
- Large capacity 19A alternator

## Mechanically Efficient DOHC 12-Valve Engine

Suzuki engineers based this design utilizing Suzuki's proven in-line three-cylinder 12-valve engine. This high performance engine has a displacement of 941cm<sup>3</sup> and features a DOHC powerhead—the only DOHC engine used in the 40 / 50 / 60 HP outboard class—with four valves per cylinder, and an air intake system optimized for maximum efficiency in the high rpm range. When designing this engine, Suzuki engineers also focused on improving mechanical efficiency. Each component was analyzed and redesigned to reduce mechanical loss in order to improve efficiency. As an example, a new oil pump design makes internal oil flow more efficient, keeping moving parts better lubricated while using less energy. The combined reduction in mechanical loss throughout the engine contributes to better fuel economy.



# PRODUCT INFORMATION DF40A, 50A & 60A WITH LEAN BURN

## Suzuki's Lean Burn Control System

Suzuki's Lean Burn Control System is an intelligent system that monitors engine performance and operating conditions to predict fuel needs and deliver a leaner fuel mixture to the engine. First introduced on the DF90A / 70A, this system provides remarkable improvements in fuel economy from low speed operation up into the cruising range, which is where the engine is used a majority of the time. In-house testing shows

that at medium speeds, the DF50A achieves a 23% improvement in fuel consumption than its predecessor.

## Suzuki Easy Start System

Starts are quick and easy with Suzuki's Easy Start System. No need to hold the key, just turn it once and the starter system stays engaged until the engine starts. The system delivers smoother and improved starts to get you up and running quicker.

**Comparison of Running Distance per 1 Liter of Fuel**  
(New DF50 vs. Original DF50)

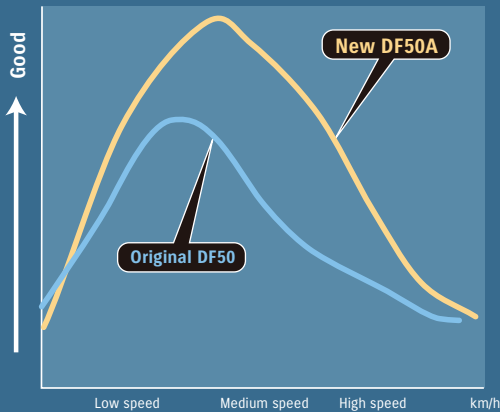

Data used in the graphs were obtained through in-house testing under uniformed conditions. Results will vary depending upon operating conditions (boat design, size, weight, weather, etc.)

**Top Speed Comparison** (New DF50A vs. Original DF50)

Original DF50 Max. Speed = 100%



**Acceleration Time Comparison 48km/h (0-30mph)**

(New DF50A vs. Original DF50)

Original DF50 Acceleration Time = 100%

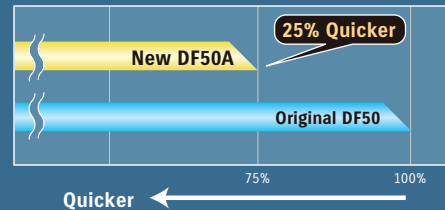

## Maintenance Free Timing Chain

The DF40A / 50A / 60A are the only outboards in this outboard class to incorporate a timing chain. The chain is oil-bathed, self adjusting, and maintenance free to provide boaters with years of dependable service.

## Large Capacity 19A Alternator

The DF40A / 50A / 60A are equipped with a powerful 19A alternator that generates approximately 11.5A even with the engine running at a low 1,000 rpm. Under normal circumstances that's enough power to keep an assortment of marine electronics operating in most situations.

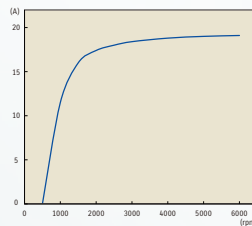

## Multi-Point Sequential Electronic Fuel Injection

Suzuki pioneered the use of multi-point sequential electronic fuel injection in four-stroke outboards. This advanced, time-tested system gathers operating data from a series of sensors located in key areas on the engine, processes the data and calculates the optimum amount of fuel and air needed for the engine—all in real time. Boaters benefit with smooth starts, maximum operating efficiency, excellent fuel economy, and reduced emissions.

## Anti Corrosion System

Suzuki protects the outboard's exterior from harmful corrosion with its own specially formulated anti-corrosion finish. Applying the finish directly to the outboard's aluminum surface, allows maximum bonding of the finish to the surface to increase durability and help protect parts that are constantly exposed to saltwater.

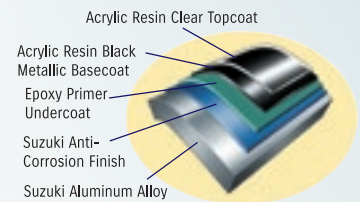

## New Tilt Limit System

The DF60A incorporates a new tilt limit system to help protect the boat from damage that can occur when tilting the outboard. The design incorporates both the functions of a tilt limit and trim sender, and uses a step-free, continuous type tilt limiter that allows installation of the outboard on nearly any type of boat.

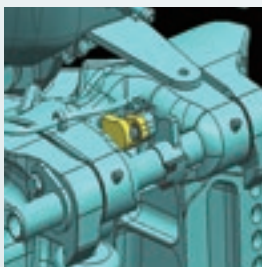

## Suzuki Troll Mode System

Suzuki has something new for the "Fishing Aficionados", the "Suzuki Troll Mode System". Fishermen know that precise control of trolling speed makes a tremendous difference in the presentation of bait and lures – and the resulting catch. New DF40A, DF50A, DF60A, DF70A, DF90A, DF115A, DF140A, DF150G, DF175G, DF200A, DF250AP, and DF300AP outboards will come equipped with this system. The operator can increase or decrease the engine speed in 50 rpm increments with the simple touch of an optional function rocker switch located near the helm. The Suzuki Troll Mode System can be utilized with an "in gear" (forward or reverse) engine operating range from idle – 1200 rpm.

# Suzuki Motor Corporation

## A tradition of Innovation

Suzuki history begins with the founding of Suzuki Loom Works by Michio Suzuki in October 1909. Realizing that weaver wanted to produce cloth both vertical and horizontal patterns, he developed an automated loom capable of weaving patterned cloth from space dyed yarn. His commitment to innovative engineering was the start of an uncompromising focus on creating products that meet people's needs and offer new life style possibilities.

While the company has evolved, diversified, and expanded since then, we have always honored our founder's commitment to innovative engineering. His philosophy lives on in the "Way of Life!" brand slogan and our dedication to provide our customers with value packed products that bring satisfaction and meet their needs.

## Suzuki Motorcycles, ATVs & Scooters

Suzuki's full lineup of motorcycles, ATVs and scooters lead the industry with cutting-edge technology, convenient features, unrivaled performance and superior quality.

With a broad lineup that includes sportbikes, cruisers, motocross, dual-sport, adventure, scooters, ATVs and more – Suzuki has built its reputation on performance and innovation. Suzuki's motorcycles, ATVs and scooters have revolutionized the industry and redefined their categories. The rugged KingQuad ATV line celebrates 30 years as the "First on 4-Wheels." The legendary GSX-R line, which practically invented the modern sportbike when introduced in 1986, celebrates the unprecedented milestone of over 1 million units produced worldwide. Suzuki's other product lines, including Burgman scooters, Boulevard cruisers

and V-Strom adventure motorcycles, continue to innovate and set the industry-standard for performance, features, quality and value.

## Suzuki Outboards

Ranging from the world's first 300 hp four-stroke outboard to the portable DF2.5, Suzuki offers a comprehensive lineup that represents state-of-the-art design and technology. These engines offer great fuel efficiency and environmentally responsible operation that meet many of the toughest emission standards – worldwide. In 2008 Suzuki introduced the first "New Generation" four-stroke outboard motors, the DF90A and DF70A, followed by the DF60A in 2009. 2010 was another big year with the introduction of the NMMA Innovation Award Winning (Sixth Time) DF50A/40A with Lean Burn and the redesigned

DF300A with Lean Burn. 2011 followed up with additional design changes for the DF300AP to include the NMMA Innovation Award Winning (Seventh Time) Select Rotation drive system. In 2012 Suzuki introduced the NMMA Innovation Award –Honorable Mention- DF20A/15A with Battery-less EFI/Lean Burn and the redesigned DF115A/DF140A with Lean Burn. In the same year, Suzuki also added the DF250AP with Lean Burn, Select Rotation and Suzuki Precision Control. These outboards deliver clean running economical operation with Suzuki's Lean Burn Technology. At Suzuki, our goal is to build outboards that

are highly efficient, deliver low fuel consumption and high power output while placing less stress on the environment.

## Suzuki Motorsports

On the track, Suzuki has captured major championships around the world. The experience, knowledge and expertise gained on the track produces race proven, leading edge technologies that are utilized in every vehicle we make. Suzuki supplies you with the best combination of performance, durability, reliability, efficiency, ease-of-use, and value. It's why Champions Choose Suzuki. So, what are you gonna ride?

To learn more about Suzuki, visit your local Suzuki dealer or go to

[www.suzuki.com](http://www.suzuki.com)

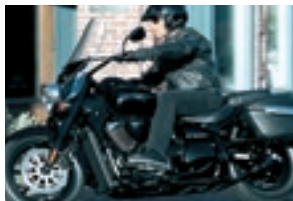

## SPECIFICATIONS

MODELS	DF40A	DF50A	DF60A
ENGINE TYPE	4-stroke DOHC 12-valve		
FUEL DELIVERY SYSTEM	Multi Point Sequential Electronic Fuel Injection		
RECOMMENDED TRANSOM HEIGHT in.	L: 20		
STARTING SYSTEM	Electric		
WEIGHT LBS.	L: 229		
NO. OF CYLINDERS	In-Line 3		
DISPLACEMENT	57.4 cu. in (941cc)		
BORE x STROKE in. (mm)	2.85 x 2.99 (72.5x76.0)		
MAXIMUM OUTPUT HP / rpm	40 HP / 5,500 rpm	50 HP / 5,800 rpm	60 HP / 5,800 rpm
FULL THROTTLE OPERATING RANGE rpm	5,000 / 6,000 rpm	5,300 / 6,300 rpm	
STEERING	Remote		
OIL PAN CAPACITY	2.9 qt (2.71 l.)		
IGNITION SYSTEM	Fully transistorized		
ALTERNATOR	12V 19A		
ENGINE MOUNTING	Shear Mount		
TRIM METHOD	Power Trim and Tilt		
GEAR RATIO	2.27:1		
GEAR SHIFT	F-N-R		
EXHAUST	Through Prop Hub Exhaust		
DRIVE PROTECTION	Rubber Hub		
PROPELLER SIZE (in.) Diameter x Pitch	11-1/2 x 9 11-1/2 x 10 11-1/2 x 11 11-5/8 x 12 11-1/2 x 13	11-3/8 x 14 11-1/4 x 15 11-1/8 x 16 11 x 17	

\* The weight of the motors are "Dry-Weight," not including propeller.

\* Boats and motors come in a large variety of combinations. See your authorized dealer for correct propeller selection to meet recommended RPM range at W.O.T.

Please read your owner's manual carefully. Remember, boating and alcohol or other drugs don't mix. Always use a USCG-approved life jacket. Please operate your outboard safely and responsibly. Suzuki encourages you to operate your boat safely and with respect for the marine environment.

SUZUKI MOTOR CORPORATION reserves the right to change, without notice or obligation, equipment, specifications, colors, materials and other items to apply to local conditions. Each model may be discontinued without notice. Please inquire at your local dealer for details of any such changes.

Actual body colors may differ slightly from the colors in this brochure.

\* Exhaust emission standards set by the U.S. Environmental Protection Agency.

\*\* Exhaust emission standards set by the California Air Resources Board.

## DF40A/50A/60A FEATURES

- Suzuki Troll Mode System
- High Performance DOHC 12-valve engine
- Lightest outboard in the 60 HP class
- Suzuki's lean burn technology delivers top level fuel efficiency
- New tilt limit system incorporates both tilt limit and trim sender functions—DF60A
- Electronic Fuel Injection
- Maintenance free timing chain
- Large Capacity 19A alternator
- Direct Ignition
- Oil Change Reminder System
- Low Oil Pressure Caution
- Over-Rev Limiter
- Overheat Cooling Water Caution
- Self Diagnostic System
- Anti-Corrosion Protection
- Freshwater Engine Flush Port



**2011  
NMMA  
INNOVATION  
AWARD  
WINNER**

**Most innovative new product in the Outboard Engine Category as voted by a panel of esteemed BWI marine journalists. The DF40A / DF50A delivers top end features to a smaller, neater power plant.**



### CARB THREE-STAR LABEL

The three-star label identifies engines that meet the California Air Resources Board's most stringent exhaust emission requirements for outboard motors.



### EPA 2010 LABEL

Suzuki's four-stroke technology is compliant with EPA's stringent 2010 exhaust emission standards and 2010-later evaporative emission standards set by the U.S. Environmental Protection Agency.



**SUZUKI MOTOR OF AMERICA, INC.**  
P.O. BOX 1100 BREA, CA 92822-1100  
[www.suzukimarine.com](http://www.suzukimarine.com)